

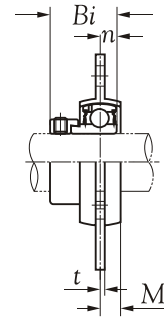

Technical Information

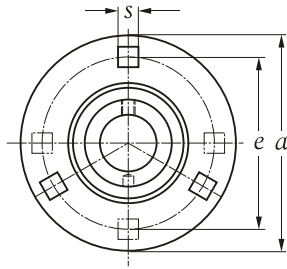

Shaft dia. mm inch	Unit number	Nominal dimensions							Bolt size mm inch	Bearing number	Housing number	Mass of unit Kg
		<i>a</i>	<i>e</i>	<i>t</i>	<i>s</i>	<i>M</i>	<i>Bi</i>	<i>n</i>				
12 1/2	SAPF 201	81	63.5	2.0	7.1	7.0	28.5	6.0	M 6	SA 201	PF 203	0.27
	SAPF 201-8	3-3/16	2-1/2	5/64	9/32	9/32	1.1220	0.2362	1/4	SA 201-8		0.27
15 9/16 5/8	SAPF 202	81	63.5	2.0	7.1	7.0	28.5	6.0	M 6	SA 202	PF 203	0.26
	SAPF 202-9	3-3/16	2-1/2	5/64	9/32	9/32	1.1220	0.2362	1/4	SA 202-9		0.26
	SAPF 202-10									SA 202-10		0.26
17 11/16	SAPF 203	81	63.5	2.0	7.1	7.0	28.5	6.0	M 6	SA 203	PF 203	0.25
	SAPF 203-11	3-3/16	2-1/2	5/64	9/32	9/32	1.1220	0.2362	1/4	SA 203-11		0.25
20 3/4	SAPF 204	90	71.5	2.0	9.0	8.0	29.5	7.0	M 8	SA 204	PF 204	0.34
	SAPF 204-12	3-35/64	2-13/16	5/64	23/64	5/16	1.1614	0.2756	5/16	SA 204-12		0.35
25 13/16 7/8 15/16 1	SAPF 205	95	76.0	2.0	9.0	9.0	30.5	7.5	M 8	SA 205	PF 205	0.40
	SAPF 205-13									SA 205-13		0.43
	SAPF 205-14	3-47/64	2-63/64	5/64	23/64	23/64	1.2008	0.2953	5/16	SA 205-14		0.42
	SAPF 205-15									SA 205-15		0.41
	SAPF 205-16									SA 205-16		0.38
30 1-1/16 1-1/8 1-3/16 1-1/4	SAPF 206	113	90.5	2.6	11.0	9.5	33.9	8.0	M 10	SA 206	PF 206	0.65
	SAPF 206-17									SA 206-17		0.69
	SAPF 206-18	4-29/64	3-9/16	7/64	7/16	3/8	1.3346	0.3150	3/8	SA 206-18		0.67
	SAPF 206-19									SA 206-19		0.63
	SAPF 206-20									SA 206-20		0.60
35 1-1/4 1-5/16 1-3/8 1-7/16	SAPF 207	122	100.0	2.6	11.0	11.0	37.5	8.5	M 10	SA 207	PF 207	0.86
	SAPF 207-20									SA 207-20		0.92
	SAPF 207-21	4-51/64	3-15/16	7/64	7/16	7/16	1.4764	0.3543	3/8	SA 207-21		0.89
	SAPF 207-22									SA 207-22		0.87
	SAPF 207-23									SA 207-23		0.84