

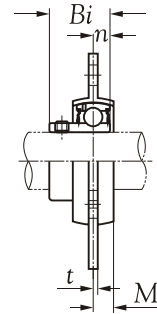

Technical Information

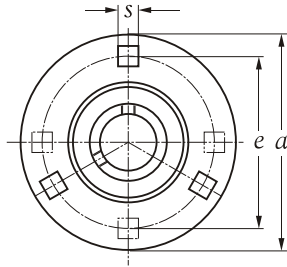

Shaft dia. mm inch	Unit number	Nominal dimensions							Bolt size mm inch	Bearing number	Housing number	Mass of unit Kg
		a	e	t	s	M	Bi	n				
12 1/2	SBPF 201	81	63.5	2.0	7.1	7.0	22	6.0	M 6	SB 201	PF 203	0.23
	SBPF 201-8	3-3/16	2-1/2	5/64	9/32	9/32	0.8661	0.2362	1/4	SB 201-8		0.23
15 9/16 5/8	SBPF 202	81	63.5	2.0	7.1	7.0	22	6.0	M 6	SB 202	PF 203	0.22
	SBPF 202-9	3-3/16	2-1/2	5/64	9/32	9/32	0.8661	0.2362	1/4	SB 202-9		0.22
	SBPF 202-10	3-3/16	2-1/2	5/64	9/32	9/32	0.8661	0.2362	1/4	SB 202-10		0.22
17 11/16	SBPF 203	81	63.5	2.0	7.1	7.0	22	6.0	M 6	SB 203	PF 203	0.21
	SBPF 203-11	3-3/16	2-1/2	5/64	9/32	9/32	0.8661	0.2362	1/4	SB 203-11		0.21
20 3/4	SBPF 204	90	71.5	2.0	9.0	8.0	25	7.0	M 8	SB 204	PF 204	0.29
	SBPF 204-12	3-35/64	2-13/16	5/64	23/64	5/16	0.9843	0.2756	5/16	SB 204-12		0.31
25 13/16 7/8 15/16 1	SBPF 205	95	76.0	2.0	9.0	9.0	27	7.5	M 8	SB 205	PF 205	0.37
	SBPF 205-13	95	76.0	2.0	9.0	9.0	27	7.5	M 8	SB 205-13		0.40
	SBPF 205-14	3-47/64	2-63/64	5/64	23/64	23/64	1.0630	0.2953	5/16	SB 205-14		0.39
	SBPF 205-15	3-47/64	2-63/64	5/64	23/64	23/64	1.0630	0.2953	5/16	SB 205-15		0.38
	SBPF 205-16	3-47/64	2-63/64	5/64	23/64	23/64	1.0630	0.2953	5/16	SB 205-16		0.36
30 1-1/16 1-1/8 1-3/16 1-1/4	SBPF 206	113	90.5	2.6	11.0	9.5	29	8.0	M 10	SB 206	PF 206	0.58
	SBPF 206-17	113	90.5	2.6	11.0	9.5	29	8.0	M 10	SB 206-17		0.60
	SBPF 206-18	4-29/64	3-9/16	7/64	7/16	3/8	1.1417	0.3150	3/8	SB 206-18		0.59
	SBPF 206-19	4-29/64	3-9/16	7/64	7/16	3/8	1.1417	0.3150	3/8	SB 206-19		0.57
	SBPF 206-20	4-29/64	3-9/16	7/64	7/16	3/8	1.1417	0.3150	3/8	SB 206-20		0.56
35 1-1/4 1-5/16 1-3/8 1-7/16	SBPF 207	122	100.0	2.6	11.0	11.0	32	8.5	M 10	SB 207	PF 207	0.74
	SBPF 207-20	122	100.0	2.6	11.0	11.0	32	8.5	M 10	SB 207-20		0.79
	SBPF 207-21	4-51/64	3-15/16	7/64	7/16	7/16	1.2598	0.3543	3/8	SB 207-21		0.78
	SBPF 207-22	4-51/64	3-15/16	7/64	7/16	7/16	1.2598	0.3543	3/8	SB 207-22		0.77
	SBPF 207-23	4-51/64	3-15/16	7/64	7/16	7/16	1.2598	0.3543	3/8	SB 207-23		0.73