

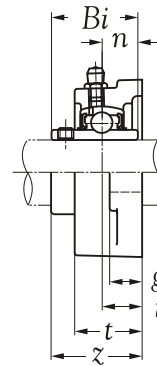

Technical Information

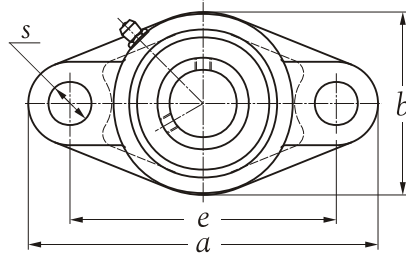

Shaft dia. mm inch	Unit number	Nominal dimensions										Bolt size mm inch	Bearing number	Housing number	Mass of unit Kg
		a	e	i	g	t	b	s	z	Bi	n				
25	UCFL X05	141	117	18	13	30	83	12	40.2	38.1	15.9	M 10	UC X05	FL X05	0.95
13/16	UCFL X05-13												UC X05-13		1.00
7/8	UCFL X05-14												UC X05-14		0.98
15/16	UCFL X05-15	5-35/64	4-39/64	45/64	3/64	1-3/16	3-17/64	15/32	1-37/64	1.5000	0.6260	3/8	UC X05-15		0.96
1	UCFL X05-16												UC X05-16		0.94
30	UCFL X06	156	130	19	14	34	95	16	44.4	42.9	17.5	M 14	UC X06	FL X06	1.34
1-1/16	UCFL X06-17												UC X06-17		1.36
1-1/8	UCFL X06-18												UC X06-18		1.35
1-3/16	UCFL X06-19	6-9/64	5-1/8	3/4	19/32	1-11/32	3-47/64	5/8	1-3/4	1.6890	0.6890	1/2	UC X06-19		1.32
1-1/4	UCFL X06-20												UC X06-20		1.31
35	UCFL X07	171	144	21	14	38	105	16	51.2	49.2	19.0	M 14	UC X07	FL X07	1.74
1-1/4	UCFL X07-20												UC X07-20		1.78
1-5/16	UCFL X07-21												UC X07-21		1.77
1-3/8	UCFL X07-22	6-47/64	5-43/64	53/64	5/8	1-1/2	4-9/64	5/8	2-1/64	1.9370	0.7480	1/2	UC X07-22		1.76
1-7/16	UCFL X07-23												UC X07-23		1.72
40	UCFL X08	179	148	22	14	40	111	16	52.2	49.2	19.0	M 14	UC X08	FL X08	1.97
1-1/2	UCFL X08-24	7-1/16	5-53/64	55/64	5/8	1-37/64	4-3/8	5/8	2-1/16	1.9370	0.7480	1/2	UC X08-24		2.01
45	UCFL X09	189	157	23	14	40	116	16	55.6	51.6	19.0	M 14	UC X09	FL X09	2.18
1-5/8	UCFL X09-26												UC X09-26		2.33
1-11/16	UCFL X09-27	7-7/16	6-3/16	29/32	5/8	1-37/64	4-9/16	5/8	2-3/16	2.0315	0.7480	1/2	UC X09-27		2.24
1-3/4	UCFL X09-28												UC X09-28		2.20
50	UCFL X10	216	184	26	20	44	133	19	59.4	55.6	22.2	M 16	UC X10	FL X10	3.19
1-7/8	UCFL X10-30												UC X10-30		3.33
1-15/16	UCFL X10-31	8-1/2	7-1/4	1-1/64	45/64	1-47/64	5-15/64	3/4	2-11/32	2.1890	0.8740	5/8	UC X10-31		3.22
2	UCFL X10-32												UC X10-32		3.16