

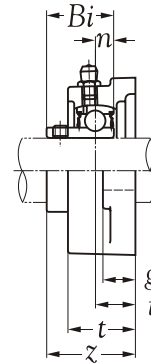

Technical Information

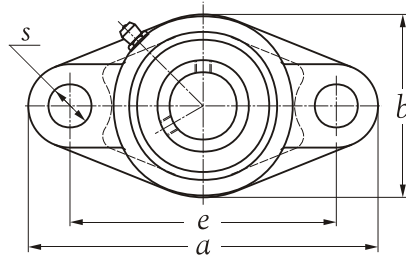

Shaft dia. mm inch	Unit number	Nominal dimensions										Bolt size mm inch	Bearing number	Housing number	Mass of unit Kg
		a	e	i	g	t	s	b	z	Bi	n				
20 3/4	SBFT 204	112.5	90.0	19	15	29.5	10.0	61	37.0	25	7.0	M 8	SB 204	FT 204	0.47
	SBFT 204-12	4-27/64	3-35/64	3/4	19/32	1-5/32	25/64	2-13/33	1-29/64	0.9843	0.2756	5/16	SB 204-12		0.49
25 13/16 7/8 15/16 1	SBFT 205	123.0	99.0	19	15	30.0	11.5	70	38.5	27	7.5	M 10	SB 205	FT 205	0.56
	SBFT 205-13												SB 205-13		0.59
	SBFT 205-14	4-27/32	3-57/64	3/4	19/32	1-3/16	29/64	2-3/5	1-3/64	1.0630	0.2953	3/8	SB 205-14		0.58
	SBFT 205-15												SB 205-15		0.57
	SBFT 205-16												SB 205-16	0.55	
30 1-1/16 1-1/8 1-3/16 1-1/4	SBFT 206	142.0	116.5	20	16	32.5	11.5	82	41.0	29	8.0	M 10	SB 206	FT 206	0.79
	SBFT 206-17												SB 206-17		0.81
	SBFT 206-18	5-19/32	4-19/32	25/32	5/8	1-9/32	29/64	3-15/65	1-39/64	1.1417	0.3150	3/8	SB 206-18		0.80
	SBFT 206-19												SB 206-19		0.78
	SBFT 206-20												SB 206-20	0.77	
35 1-1/4 1-5/16 1-3/8 1-7/16	SBFT 207	158.0	130.0	21	17	36.0	13.0	94	44.5	32	8.5	M 10	SB 207	FT 207	1.18
	SBFT 207-20												SB 207-20		1.23
	SBFT 207-21	6-7/32	5-1/8	53/64	43/64	1-27/64	3/64	3-45/65	1-3/4	1.2598	0.3543	7/16	SB 207-21		1.22
	SBFT 207-22												SB 207-22		1.21
	SBFT 207-23												SB 207-23	1.17	
40 1-1/2	SBFT 208	172.0	143.5	24	17	39.0	13.0	103	48.5	34	9.5	M 10	SB 208	FT 208	1.35
	SBFT 208-24	6-49/64	5-21/32	15/16	43/64	1-17/32	3/64	4-1/17	1-29/32	1.3386	0.3740	7/16	SB 208-24		1.39