

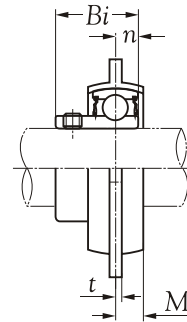

Technical Information

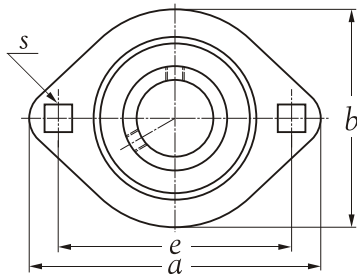

Shaft dia. mm inch	Unit number	Nominal dimensions								Bolt size mm inch	Bearing number	Housing number	Mass of unit Kg
		a	e	M	t	s	b	Bi	n				
12 1/2	SBPFL 201	81	63.5	7.0	2.0	7.1	59	22	6.0	M 6	SB 201	PFL 203	0.18
	SBPFL 201-8	3-3/16	2-1/2	9/32	5/64	9/32	2-21/64	0.8661	0.2362	1/4	SB 201-8		0.18
15 9/16 5/8	SBPFL 202	81	63.5	7.0	2.0	7.1	59	22	6.0	M 6	SB 202	PFL 203	0.17
	SBPFL 202-9	3-3/16	2-1/2	9/32	5/64	9/32	2-21/64	0.8661	0.2362	1/4	SB 202-9		0.17
	SBPFL 202-10										SB 202-10		0.17
17 11/16	SBPFL 203	81	63.5	7.0	2.0	7.1	59	22	6.0	M 6	SB 203	PFL 203	0.16
	SBPFL 203-11	3-3/16	2-1/2	9/32	5/64	9/32	2-21/64	0.8661	0.2362	1/4	SB 203-11		0.16
20 3/4	SBPFL 204	90	71.5	8.0	2.0	9.0	67	25	7.0	M 8	SB 204	PFL 204	0.22
	SBPFL 204-12	3-35/64	2-13/16	5/16	5/64	23/64	2-41/64	0.9843	0.2756	5/16	SB 204-12		0.24
25 13/16 7/8 15/16 1	SBPFL 205	95	76.0	9.0	2.0	9.0	71	27	7.5	M 8	SB 205	PFL 205	0.27
	SBPFL 205-13										SB 205-13		0.30
	SBPFL 205-14										SB 205-14		0.29
	SBPFL 205-15	3-47/64	2-63/64	23/64	5/64	23/64	2-51/64	1.0630	0.2953	5/16	SB 205-15		0.28
	SBPFL 205-16										SB 205-16		0.26
30 1-1/16 1-1/8 1-3/16 1-1/4	SBPFL 206	113	90.5	9.5	2.6	11.0	84	29	8.0	M 10	SB 206	PFL 206	0.44
	SBPFL 206-17										SB 206-17		0.46
	SBPFL 206-18	4-29/64	3-9/16	3/8	7/64	7/16	3-5/16	1.1417	0.3150	3/8	SB 206-18		0.45
	SBPFL 206-19										SB 206-19		0.43
	SBPFL 206-20										SB 206-20		0.42
35 1-1/4 1-5/16 1-3/8 1-7/16	SBPFL 207	122	100.0	11.0	2.6	11.0	94	32	8.5	M 10	SB 207	PFL 207	0.58
	SBPFL 207-20										SB 207-20		0.63
	SBPFL 207-21	4-51/64	3-15/16	7/16	7/64	7/16	3-45/64	1.2598	0.3543	3/8	SB 207-21		0.62
	SBPFL 207-22										SB 207-22		0.61
	SBPFL 207-23										SB 207-23		0.57