

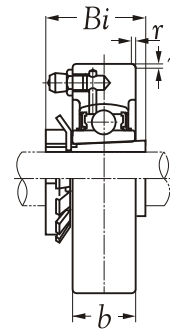

Technical Information

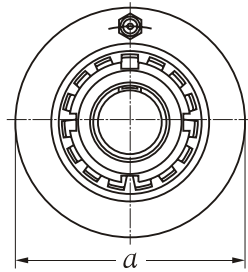

Shaft dia. Mm	Unit number	Nominal dimensions mm				Bearing number	Housing number	Mass of unit Kg
		<i>a</i>	<i>b</i>	<i>r</i>	<i>Bi</i>			
20	UKC 205	80	22	2.0	35	UK 205	C 205	0.59
25	UKC 206	85	27	2.0	38	UK 206	C 206	0.74
30	UKC 207	90	28	2.0	43	UK 207	C 207	0.80
35	UKC 208	100	30	2.5	46	UK 208	C 208	1.03
40	UKC 209	110	31	2.5	50	UK 209	C 209	1.34
45	UKC 210	120	33	2.5	55	UK 210	C 210	1.71
50	UKC 211	125	35	2.5	59	UK 211	C 211	1.86
55	UKC 212	130	38	2.5	62	UK 212	C 212	1.98
60	UKC 213	140	40	3.0	65	UK 213	C 213	2.47