

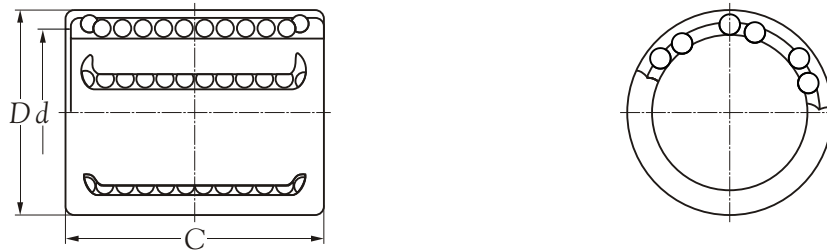

Technical Information



Inner bore <i>d</i> mm	Bearing number	Dimensions		Basic load ratings		Max runout speed		Number of ball tracks	Weight g
		<i>D</i> mm	<i>C</i> mm	dynamic <i>C</i> N	static <i>C₀</i> N	grease oil	r/min		
6	KH 0622	12	22	400	239	41	24	4	7.0
6	KH 0622 PP	12	22	400	239	41	24	4	7.0
8	KH 0824	15	24	435	280	44	29	4	12.0
8	KH 0824 PP	15	24	435	280	44	29	4	12.0
10	KH 1026	17	26	500	370	51	38	4	14.5
10	KH 1026 PP	17	26	500	370	51	38	4	14.5
12	KH 1228	19	28	620	510	63	52	5	18.5
12	KH 1228 PP	19	28	620	510	63	52	5	18.5
14	KH 1428	21	28	620	520	63	53	5	20.5
14	KH 1428 PP	21	28	620	520	63	53	5	20.5
16	KH 1630	24	30	800	620	82	63	5	27.5
16	KH 1630 PP	24	30	800	620	82	63	5	27.5
20	KH 2030	28	30	950	790	97	81	6	32.5
20	KH 2030 PP	28	30	950	790	97	81	6	32.5
25	KH 2540	35	40	1990	1670	203	170	6	66.0
25	KH 2540 PP	35	40	1990	1670	203	170	6	66.0
30	KH 3050	40	50	2800	2700	285	275	7	95.0
30	KH 3050 PP	40	50	2800	2700	285	275	7	95.0
40	KH 4060	52	60	4400	4450	449	454	8	182.0
40	KH 4060 PP	52	60	4400	4450	449	454	8	182.0
50	KH 5070	62	70	5500	6300	561	642	9	252.0
50	KH 5070 PP	62	70	5500	6300	561	642	9	252.0

