

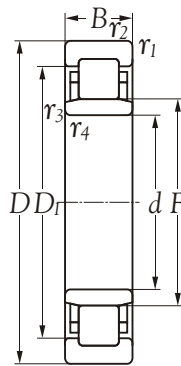

Technical Information



Inner bore <i>d</i> mm	Bearing number	Principal dimensions		Basic load ratings		Max runout speed		Mass kg
		<i>D</i> mm	<i>B</i> mm	dynamic <i>C</i> N	static <i>C</i> ₀	grease r/min	oil r/min	
15	NU 302 EC	42	13	15500	12200	11200	13300	0.086
20	NU 304 EC	52	15	24600	20800	8400	10500	0.150
25	NU 305 EC	62	17	32100	29200	6600	8400	0.240
30	NU 306 EC	72	19	40900	38400	6300	7700	0.360
35	NU 307 EC	80	21	51500	50400	5600	6600	0.480
40	NU 308 EC	90	23	64700	62400	4600	5600	0.650
45	NU 309 EC	100	25	79200	80000	4400	5200	0.900
50	NU 310 EC	110	27	88000	89600	3500	4200	1.150
55	NU 311 EC	120	29	110400	114400	3300	3900	1.450
60	NU 312 EC	130	31	120800	128000	3000	3500	1.800
65	NU 313 EC	140	33	146400	156800	2800	3300	2.250
70	NU 314 EC	150	35	164000	182400	2500	3000	2.750
75	NU 315 EC	160	37	193600	212000	2300	2800	3.300
80	NU 316 EC	170	39	208000	232000	2200	2600	3.950
85	NU 317 EC	180	41	237600	268000	2100	2500	4.700
90	NU 318 EC	190	43	255200	288000	1900	2300	5.450
95	NU 319 EC	200	45	272800	312000	1800	2200	6.250
100	NU 320 EC	215	47	312800	352000	1600	2100	7.600
105	NU 321 EC	225	49	352000	400000	1500	1900	8.800
110	NU 322 EC	240	50	374400	432000	1400	1800	10.500
120	NU 324 EC	260	55	431200	496000	1300	1600	13.500
130	NU 326 EC	280	58	501600	600000	1200	1500	18.500
140	NU 328 EC	300	62	545600	664000	1200	1500	22.500
150	NU 330 EC	320	65	624800	772000	1100	1400	27.500
160	NU 332 EC	340	68	704000	864000	1000	1200	32.500
170	NU 334	360	72	647200	832000	1100	1300	38.500
180	NU 336	380	75	730400	944000	1000	1200	42.500
190	NU 338 EC	400	79	912000	1200000	800	1000	50.000
200	NU 340	420	80	792000	1056000	900	1100	56.000
220	NU 344	460	88	968000	1304000	800	1000	72.500
240	NU 348	500	95	1160000	1600000	700	900	94.500



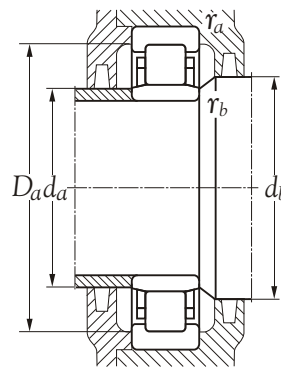

Inner bore <i>d</i> mm	Bearing number	Dimensions(mm)							Abutment and fillet dimensions(mm)						Angle ring Designation	Dimensions		Mass kg
		<i>d</i> ₁	<i>D</i> ₁	<i>F</i>	<i>r</i> _{1,2} min	<i>r</i> _{3,4} min	<i>s</i> ⁰	<i>d</i> _a min	<i>d</i> _a max	<i>d</i> _b max	<i>D</i> _a max	<i>r</i> _a max	<i>r</i> _b max	<i>B</i> ₁ mm		<i>B</i> ₂ mm		
15	NU 302 EC	24.3	33.0	21.0	1.0	0.6	1.0	19.0	20	22	37.0	1.0	0.6	HJ 302 EC	3	5.5	0.009	
20	NU 304 EC	31.2	42.4	27.5	1.1	0.6	0.9	24.0	26	29	45.5	1.0	0.6	HJ 304 EC	4	6.5	0.017	
25	NU 305 EC	38.1	50.7	34.0	1.1	1.1	1.3	31.5	32	36	55.5	1.0	1.0	HJ 305 EC	4	7.0	0.023	
30	NU 306 EC	45.0	58.9	40.5	1.1	1.1	1.4	36.5	39	42	65.5	1.0	1.0	HJ 306 EC	5	8.5	0.040	
35	NU 307 EC	51.0	66.3	46.2	1.5	1.1	1.2	41.5	44	48	72.0	1.5	1.0	HJ 307 EC	6	9.5	0.058	
40	NU 308 EC	57.5	75.6	52.0	1.5	1.5	1.4	48.0	50	54	82.0	1.5	1.5	HJ 308 EC	7	11.0	0.084	
45	NU 309 EC	64.4	83.8	58.5	1.5	1.5	1.7	53.0	56	61	92.0	1.5	1.5	HJ 309 EC	7	11.5	0.110	
50	NU 310 EC	71.2	92.1	65.0	2.0	2.0	1.9	59.0	63	67	101.0	2.0	2.0	HJ 310 EC	8	13.0	0.140	
55	NU 311 EC	77.5	101.0	70.5	2.0	2.0	2.0	64.0	68	73	111.0	2.0	2.0	HJ 311 EC	9	14.0	0.190	
60	NU 312 EC	84.3	110.0	77.0	2.1	2.1	2.1	71.0	74	79	119.0	2.0	2.0	HJ 312 EC	9	14.5	0.220	
65	NU 313 EC	90.5	119.0	82.5	2.1	2.1	2.2	76.0	80	85	129.0	2.0	2.0	HJ 313 EC	10	15.5	0.270	
70	NU 314 EC	97.3	127.0	89.0	2.1	2.1	1.8	81.0	86	91	139.0	2.0	2.0	HJ 314 EC	10	15.5	0.320	
75	NU 315 EC	104.0	136.0	95.0	2.1	2.1	1.8	86.0	92	97	149.0	2.0	2.0	HJ 315 EC	11	16.5	0.390	
80	NU 316 EC	110.0	144.0	101.0	2.1	2.1	2.1	91.0	98	104	159.0	2.0	2.0	HJ 316 EC	11	17.0	0.440	
85	NU 317 EC	117.0	153.0	108.0	3.0	3.0	2.3	98.0	105	111	167.0	2.5	2.5	HJ 317 EC	12	18.5	0.550	
90	NU 318 EC	124.0	162.0	113.5	3.0	3.0	2.5	103.0	110	116	177.0	2.5	2.5	HJ 318 EC	12	18.5	0.600	
95	NU 319 EC	132.0	170.0	121.5	3.0	3.0	2.9	108.0	118	124	187.0	2.5	2.5	HJ 319 EC	13	20.5	0.760	
100	NU 320 EC	139.0	182.0	127.5	3.0	3.0	2.9	113.0	124	130	202.0	2.5	2.5	HJ 320 EC	13	20.5	0.870	
105	NU 321 EC	145.0	190.0	133.0	3.0	3.0	3.4	118.0	130	136	212.0	2.5	2.5	HJ 321 EC	13	20.5	1.000	
110	NU 322 EC	155.0	201.0	143.0	3.0	3.0	3.0	123.0	139	146	227.0	2.5	2.5	HJ 322 EC	14	22.0	1.200	
120	NU 324 EC	168.0	219.0	154.0	3.0	3.0	3.7	133.0	150	157	247.0	2.5	2.5	HJ 324 EC	14	22.5	1.400	
130	NU 326 EC	181.0	236.0	167.0	4.0	4.0	3.7	146.0	163	170	264.0	3.0	3.0	HJ 326 EC	14	23.0	1.600	
140	NU 328 EC	195.0	252.0	180.0	4.0	4.0	3.7	156.0	176	183	284.0	3.0	3.0	HJ 328 EC	15	25.0	2.000	
150	NU 330 EC	209.0	270.0	193.0	4.0	4.0	4.0	166.0	189	196	304.0	3.0	3.0	HJ 330 EC	15	25.0	2.300	
160	NU 332 EC	221.0	286.0	204.0	4.0	4.0	4.0	176.0	200	207	324.0	3.0	3.0	HJ 332 EC	15	25.0	2.550	
170	NU 334	238.0	290.0	220.0	4.0	4.0	4.6	186.0	214	223	344.0	3.0	3.0	HJ 334	16	29.5	3.300	
180	NU 336	252.0	306.0	232.0	4.0	4.0	4.4	196.0	226	236	364.0	3.0	3.0	HJ 336	17	30.5	3.950	
190	NU 338 EC	264.0	338.0	245.0	5.0	5.0	4.3	210.0	240	249	380.0	4.0	4.0	HJ 338 EC	18	29.0	4.300	
200	NU 340	280.0	337.0	260.0	5.0	5.0	4.0	220.0	253	264	400.0	4.0	4.0	HJ 340	18	33.0	5.000	
220	NU 344	307.0	371.0	284.0	5.0	5.0	5.2	240.0	277	288	440.0	4.0	4.0	HJ 344	20	36.0	6.750	
240	NU 348	335.0	403.0	310.0	5.0	5.0	5.6	260.0	302	314	480.0	4.0	4.0	HJ 348	22	39.5	8.900	

