

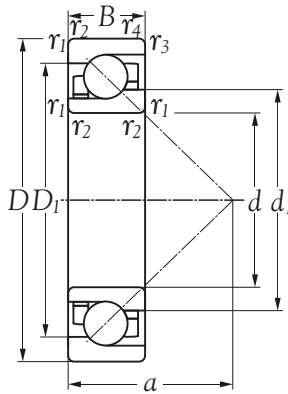

Technical Information



Inner bore <i>d</i> mm	Bearing number	Principal dimensions		Basic load ratings		Max runout speed		Mass kg
		<i>D</i> mm	<i>B</i> mm	dynamic <i>C</i> N	static <i>C</i> ₀	grease r/min	oil r/min	
12	7301BE	37	12	8400	4000	11900	16800	0.06
15	7302BE	42	13	10400	5300	10500	14000	0.08
17	7303BE	47	14	12700	6600	9100	12600	0.11
20	7304BE	52	15	15200	8300	7700	11200	0.14
25	7305BE	62	17	20800	12400	6300	9100	0.23
30	7306BE	72	19	27600	16900	5600	7700	0.34
35	7307BE	80	21	31200	19600	5200	7000	0.45
40	7308BE	90	23	39500	268000	4600	6300	0.63
45	7309BE	100	25	48400	33200	4200	5600	0.85
50	7310BE	110	27	59200	40800	3700	4900	1.10
66	7311BE	120	29	68100	48000	3300	4400	1.40
60	7312BE	130	31	76400	55600	3100	4200	1.75
65	7313BE	140	33	86400	64000	3000	3900	2.15
70	7314BE	150	35	95200	72000	2600	3500	2.65
75	7315BE	160	37	106400	84800	2500	3300	3.20
80	7316BE	170	39	114400	94400	2300	3100	3.80
85	7317BE	180	41	122400	105600	2200	3000	4.45
90	7318BE	190	43	132000	116800	2100	2800	5.20
95	7319BE	200	45	142400	130400	1900	2600	6.05
100	7320BE	215	47	162400	152000	1800	2500	7.50
105	7321BE	225	49	169600	166400	1600	2300	8.55
110	7322BE	240	50	180000	179200	1500	2200	10.00
120	7324B	260	55	190400	200000	1300	1900	14.50
130	7326B	280	58	200800	216000	1200	1800	17.50
140	7328BCB	300	62	220800	248000	1100	1600	21.50
150	7330BCB	320	65	241600	292000	1100	1500	26.00
170	7334BCB	360	72	286400	364000	900	1300	36.00
180	7336BCB	380	75	296800	392000	900	1200	42.00
190	7338BCB	400	78	328000	448000	800	1100	48.50



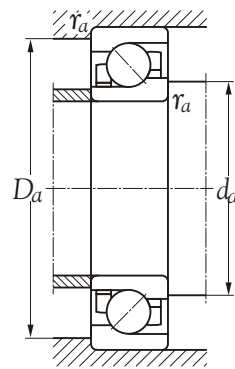

Inner bore d mm	Bearing number	Dimensions(mm)					Abutment and fillet dimensions(mm)		
		d_1	D_1	$r_{1,2}$ min	$r_{3,4}$ min	a	d_a min	D_a max	r_a max
12	7301 BE	21.7	28.3	1.0	0.6	16	18	31	1.0
15	7302 BE	25.9	32.9	1.0	0.6	19	21	36	1.0
17	7303 BE	28.6	36.5	1.0	0.6	20	23	41	1.0
20	7304 BE	32.9	41.0	1.1	0.6	23	27	45	1.0
25	7305 BE	39.4	48.9	1.1	0.6	27	32	55	1.0
30	7306 BE	46.2	57.3	1.1	0.6	31	37	65	1.0
35	7307 BE	52.4	64.2	1.5	1.0	35	44	71	1.5
40	7308 BE	59.4	72.4	1.5	1.0	39	49	81	1.5
45	7309 BE	66.3	80.7	1.5	1.0	43	54	91	1.5
50	7310 BE	73.5	89.7	2.0	1.0	47	60	100	2.0
66	7311 BE	80.0	97.6	2.0	1.0	51	65	110	2.0
60	7312 BE	87.0	106.0	2.1	1.1	55	72	118	2.0
65	7313 BE	93.8	114.0	2.1	1.1	60	77	128	2.0
70	7314 BE	100.0	123.0	2.1	1.1	64	82	138	2.0
75	7315 BE	108.0	130.0	2.1	1.1	68	87	148	2.0
80	7316 BE	114.0	139.0	2.1	1.1	72	92	158	2.0
85	7317 BE	121.0	147.0	3.0	1.1	76	99	166	2.5
90	7318 BE	128.0	155.0	3.0	1.1	80	104	176	2.5
95	7319 BE	135.0	163.0	3.0	1.1	84	109	186	2.5
100	7320 BE	144.0	176.0	3.0	1.1	90	114	201	2.5
105	7321 BE	151.0	183.0	3.0	1.1	94	119	211	2.5
110	7322 BE	160.0	195.0	3.0	1.1	99	124	226	2.5
120	7324 B	175.0	210.0	3.0	1.1	107	134	246	2.5
130	7326 B	189.0	227.0	4.0	1.5	115	148	262	3.0
140	7328 BCB	203.0	243.0	4.0	1.5	123	158	282	3.0
150	7330 BCB	218.0	258.0	4.0	1.5	131	168	302	3.0
170	7334 BCB	246.0	292.0	4.0	1.5	147	188	342	3.0
180	7336 BCB	260.0	308.0	4.0	2.0	156	198	362	3.0
190	7338 BCB	275.0	323.0	5.0	2.0	164	212	378	4.0

