

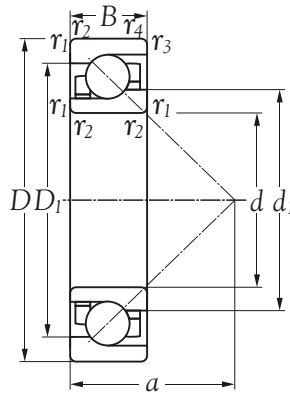

Technical Information



Inner bore <i>d</i> mm	Bearing number	Principal dimensions		Basic load ratings		Max runout speed		Mass kg
		<i>D</i> mm	<i>B</i> mm	dynamic <i>C</i> N	static <i>C</i> <sub>0</sub>	grease r/min	oil r/min	
10	7200 BE	30	9	5600	2600	13300	19600	0.030
12	7201 BE	32	10	6000	3000	12600	18200	0.036
15	7202 BE	35	11	7000	3800	11900	16800	0.045
17	7203 BE	40	12	8800	4800	10500	14000	0.065
20	7204 BE	47	14	11200	6600	8400	11900	0.110
25	7205 BE	52	15	12400	8100	7000	10500	0.130
30	7206 BE	62	16	19000	12400	5900	8400	0.200
35	7207 BE	72	17	24500	16600	5600	7700	0.280
40	7208 BE	80	18	29100	20800	4900	6600	0.370
45	7209 BE	85	19	30100	22400	4600	6300	0.420
50	7210 BE	90	20	31200	24400	4200	5600	0.470
55	7211 BE	100	21	39000	30400	3900	5200	0.620
60	7212 BE	110	22	45700	36400	3500	4600	0.800
65	7213 BE	120	23	53000	43200	3100	4200	1.000
70	7214 BE	125	24	57200	48000	3000	3900	1.100
75	7215 BE	130	25	58200	51200	3000	3900	1.200
80	7216 BE	140	26	66500	58800	2600	3500	1.450
85	7217 BE	150	28	76400	66400	2500	3300	1.850
90	7218 BE	160	30	86400	77200	2300	3100	2.300
95	7219 BE	170	32	99200	86400	2200	3000	2.700
100	7220 BE	180	34	108000	97600	2100	2800	3.300
105	7221 BE	190	36	118400	109600	1900	2600	3.950
110	7222 BE	200	38	130400	122400	1800	2500	4.600
120	7224 B	215	40	132000	130400	1500	2200	6.100
130	7226 B	230	40	148800	154400	1300	1900	6.950
140	7228 B	250	42	145600	156800	1200	1800	8.850
150	7230 BCB	270	45	156000	179200	1100	1600	11.500
160	7232 BCB	290	48	159200	188800	1100	1500	14.000
170	7234 BCB	310	52	176800	216000	1100	1500	17.500
180	7236 BCB	320	52	200800	256000	1000	1400	18.000
190	7238 BCB	340	55	220800	284000	900	1300	22.000
220	7244 BCB	400	65	255200	372000	700	1100	37.000
240	7248 BCB	440	72	291200	432000	700	1000	49.000



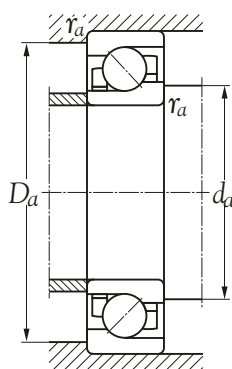

Inner bore $d$ mm	Bearing number	Dimensions(mm)					Abutment and fillet dimensions(mm)		
		$d_1$	$D_1$	$r_{1,2}$ min	$r_{3,4}$ min	$a$	$d_a$ min	$D_a$ max	$r_a$ max
10	7200 BE	18.2	23.1	0.6	0.3	13	15	25	0.6
12	7201 BE	20.2	25.1	0.6	0.3	14	17	27	0.6
15	7202 BE	22.7	28.0	0.6	0.3	16	20	30	0.6
17	7203 BE	25.9	31.9	0.6	0.6	18	22	35	0.6
20	7204 BE	30.7	37.2	1.0	0.6	21	26	41	1.0
25	7205 BE	35.7	42.2	1.0	0.6	24	31	46	1.0
30	7206 BE	42.3	50.8	1.0	0.6	27	36	56	1.0
35	7207 BE	49.3	59.0	1.1	0.6	31	42	65	1.0
40	7208 BE	55.9	66.3	1.1	0.6	34	47	73	1.0
45	7209 BE	60.5	70.9	1.1	0.6	37	52	78	1.0
50	7210 BE	65.5	75.9	1.1	0.6	39	57	83	1.0
55	7211 BE	72.4	84.1	1.5	1.0	43	64	91	1.5
60	7212 BE	79.3	92.5	1.5	1.0	47	69	101	1.5
65	7213 BE	86.3	101.0	1.5	1.0	50	74	111	1.5
70	7214 BE	91.3	106.0	1.5	1.0	53	79	116	1.5
75	7215 BE	96.5	111.0	1.5	1.0	56	84	121	1.5
80	7216 BE	103.0	119.0	2.0	1.0	59	90	130	2.0
85	7217 BE	110.0	128.0	2.0	1.0	63	95	140	2.0
90	7218 BE	117.0	136.0	2.0	1.0	67	100	150	2.0
95	7219 BE	124.0	144.0	2.1	1.1	72	107	158	2.0
100	7220 BE	131.0	152.0	2.1	1.1	76	112	168	2.0
105	7221 BE	138.0	160.0	2.1	1.1	80	117	178	2.0
110	7222 BE	145.0	169.0	2.1	1.1	84	122	188	2.0
120	7224 B	157.0	180.0	2.1	1.1	90	132	203	2.0
130	7226 B	169.0	193.0	3.0	1.1	96	144	216	2.5
140	7228 B	184.0	208.0	3.0	1.1	103	154	236	2.5
150	7230 BCB	199.0	223.0	3.0	1.1	111	164	256	2.5
160	7232 BCB	211.0	241.0	3.0	1.1	118	174	276	2.5
170	7234 BCB	224.0	258.0	4.0	1.5	127	188	292	3.0
180	7236 BCB	236.0	266.0	4.0	1.5	131	198	302	3.0
190	7238 BCB	251.0	282.0	4.0	1.5	139	208	322	3.0
220	7244 BCB	294.0	328.0	4.0	1.5	164	238	382	3.0
240	7248 BCB	322.0	361.0	4.0	1.5	180	258	422	3.0

